

# 1/3-type Variable Focal Lenses

(For 1/3-type CCD Cameras)

Unit = mm (inches)

## WV-LZA61/2S

2x Variable Focal  
ALC Lens

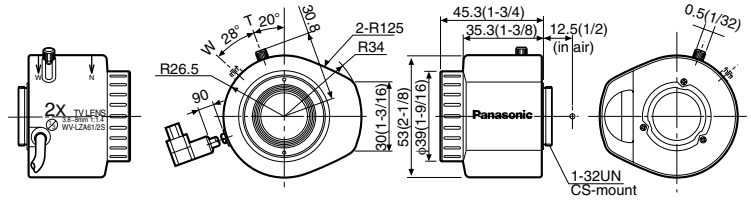

<b>Focal Length</b>	3.8 - 8 mm	<b>Iris Type</b>	Automatic
<b>Aperture Ratio</b>	F1.4 (Wide) to F176, close F1.8 (Tele) to F176, close	<b>Minimum Object Distance</b>	1.2 m (3.9 ft.) - ∞
<b>Image Size</b>	4.8(H) x 3.6(V) mm (ø6 mm)	<b>Optical Filter Size</b>	M30.5 mm, P = 0.5 mm
<b>Angular Field of View</b>	<b>H</b> 35.6°(Tele) 73.6°(Wide) <b>V</b> 26.6°(Tele) 53.4°(Wide)	<b>Mount</b>	Special C-Mount (CS-Mount, 1-32UN)
		<b>Weight</b>	75 g (0.17 lbs.)
		<b>Dimensions (W x H x D)</b>	60.5 x 53 x 45.3 mm (2-3/8"x2-1/8"x1-13/16")

## WV-LZ62/8S

8x Variable Focal  
ALC Lens

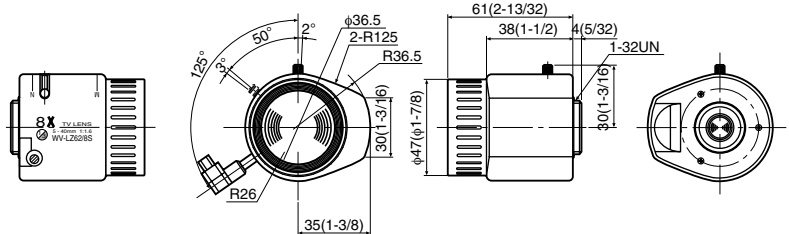

<b>Focal Length</b>	5 - 40 mm	<b>Iris Type</b>	Automatic
<b>Aperture Ratio</b>	F1.6 (Wide) to F176, close F1.9 (Tele) to F176, close	<b>Minimum Object Distance</b>	1.2 m (3.9 ft.) - ∞
<b>Image Size</b>	4.8(H) x 3.6(V) mm (ø6 mm)	<b>Optical Filter Size</b>	None
<b>Angular Field of View</b>	<b>H</b> 6.6°(Tele) 52°(Wide) <b>V</b> 5.0°(Tele) 39.6°(Wide)	<b>Mount</b>	Special C-Mount (CS-Mount, 1-32UN)
		<b>Weight</b>	110 g (0.24 lbs.)
		<b>Dimensions (W x H x D)</b>	61 x 52 x 65 mm (2-13/32"x2-1/16"x2-9/16")

Unit = mm (inches)